

# Problem 73

Your measurements of a traverse are as shown. The fixed distance between points 1 and 8 is  $84^{\circ}00'00''$  E 1200.000'. Adjust the traverse by the compass (or bowditch) rule.

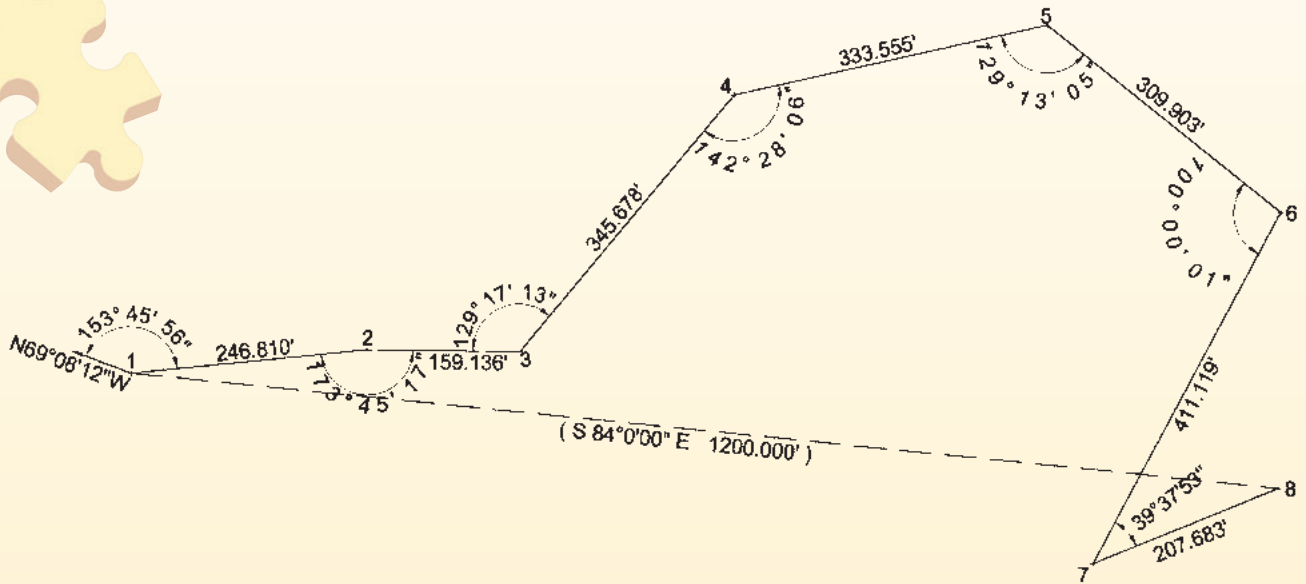

# Problem 74

First, from the original calculated coordinates of the point in Problem 73, inverse to the corrected coordinates.

Second, starting at point 1 being 0+00, calculate stations along the original traverse for each point. Divide each station by the total length of the traverse and multiply by 2.0653 (the misclosure length in the traverse).

What is the pattern?

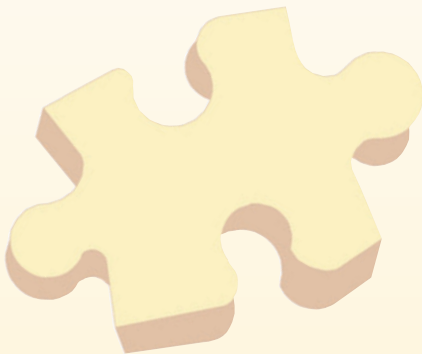

The problems for this column are contributed by retired California surveyor Dave Lindell, LS.

Solutions can be found on our website at [www.profsurv.com](http://www.profsurv.com)