

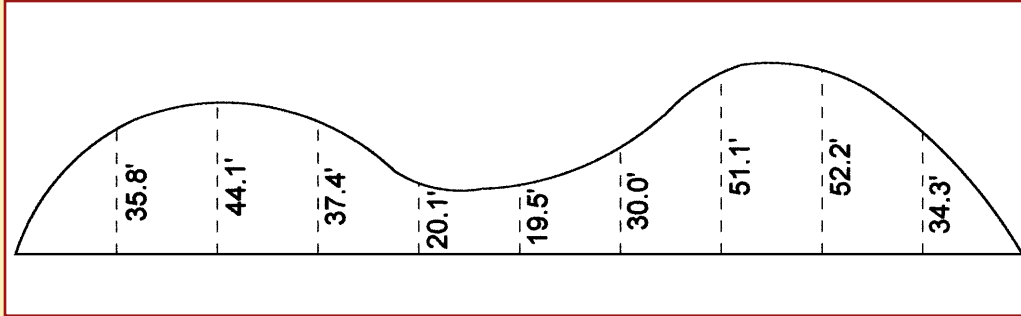

THE PROBLEM CORNER

This month's challenges involve finding an area and determining coordinates of a point. Solutions can be found on our website at www.profsurv.com.

Problem Number 29



Daniel and Jennifer took offsets to an irregular boundary at 28' intervals from a baseline they established, as shown. What is the area bounded by the baseline and the boundary?

Problem Number 30

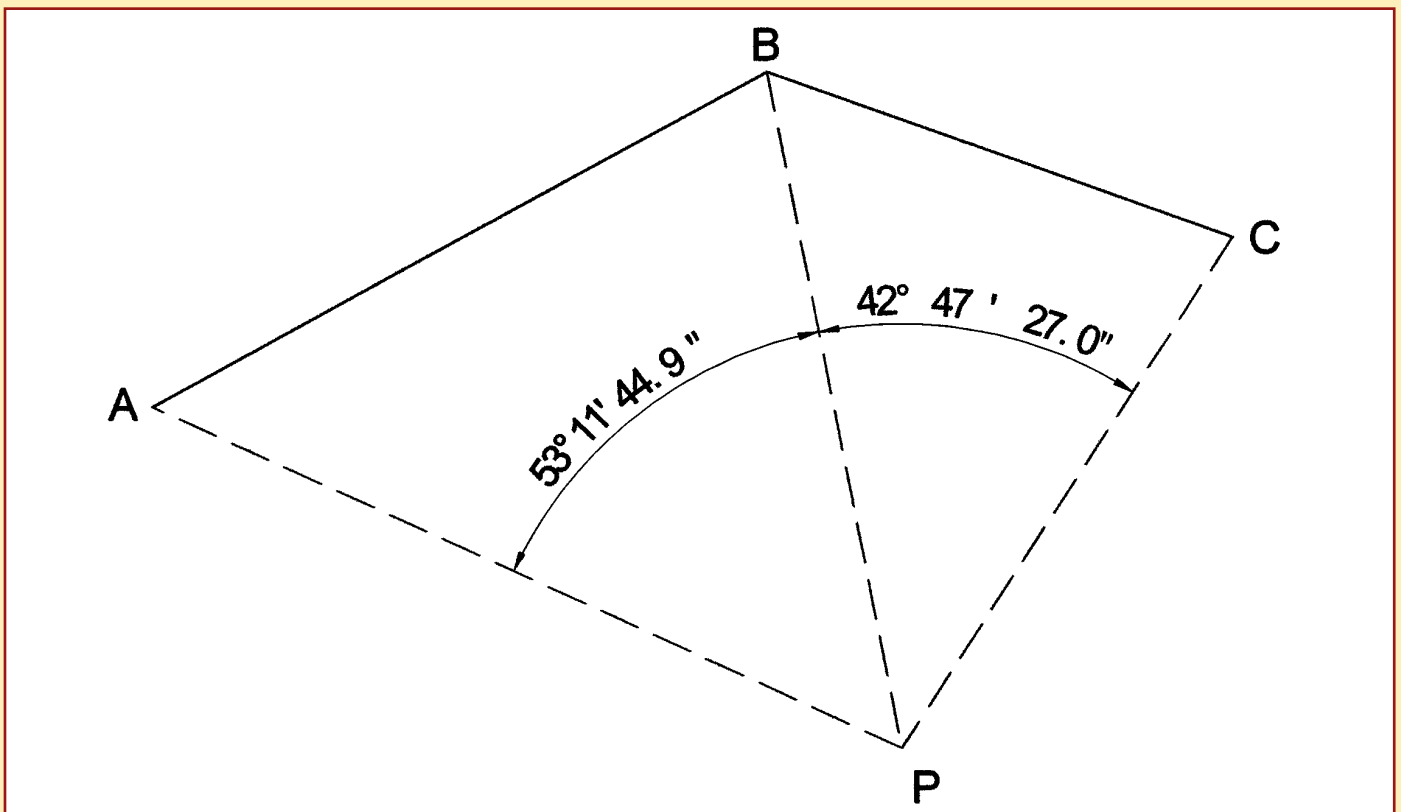

The coordinates of Point A = N 10,176.26 and E 9,663.98, B = N 10,383.22 and E 10034.61, C = N 10,291.53 and E 10321.01. Given the two measured angles from Point P, what are the coordinates of Point P?

The problems for this column are contributed by retired California surveyor Dave Lindell, LS.